



MUNI



Co-funded by the
Erasmus+ Programme
of the European Union

ERASMUS+ PROGRAMME

ERASMUS+ - KEY ACTION 2

CAPACITY BUILDING IN THE FIELD OF HIGHER EDUCATION

PROJECT NO: 585980-EPP-1-2017-1-DE-CBHE-JP

TRAINING FOR MEDICAL EDUCATION VIA INNOVATIVE
ETECHNOLOGY /MEDITEC

JANUARY 14-18, 2019

PROGRAMME FOR TRAINING IN BRNO

MASARYK UNIVERSITY, FACULTY OF MEDICINE, CENTER FOR HEALTHCARE
QUALITY, BRNO, CZECH REPUBLIC

MASARYK UNIVERSITY

BRNO, CZECH REPUBLIC

MUNI
MED



MUNI



Co-funded by the
Erasmus+ Programme
of the European Union



FACULTY OF MEDICINE

GENERAL INFO



MUNI



Co-funded by the
Erasmus+ Programme
of the European Union



- NEW AND MODERN STATE-OF-THE-ART FACILITIES (THEIR CONSTRUCTION WAS FINISHED IN 2010)
- 42 000 SQUARE METERS, 66 DEPARTMENTS AND CLINICS

NEW CAMPUS



MUNI



Co-funded by the
Erasmus+ Programme
of the European Union

- 1244 EMPLOYEES (681 FEMALES) WITH TECHNICAL STAFF
 - 792 (TEACHERS)
 - 1209 (TEACHING STAFF WITH EXTERNALS)
- 4363 STUDENTS (2806 FEMALES)
 - 742 (BACHLEOR DEGREE)
 - 2881 (MASTER DEGREE)
 - 538 (DOCTOR DEGREE)

FACULTY OF MEDICINE

GENERAL INFO



MUNI



Co-funded by the
Erasmus+ Programme
of the European Union

- MORE THAN HALF A MILLION VOLUMES
- SEATS FOR 600 STUDENTS
- STUDY ROOMS
- COMPUTER ROOMS

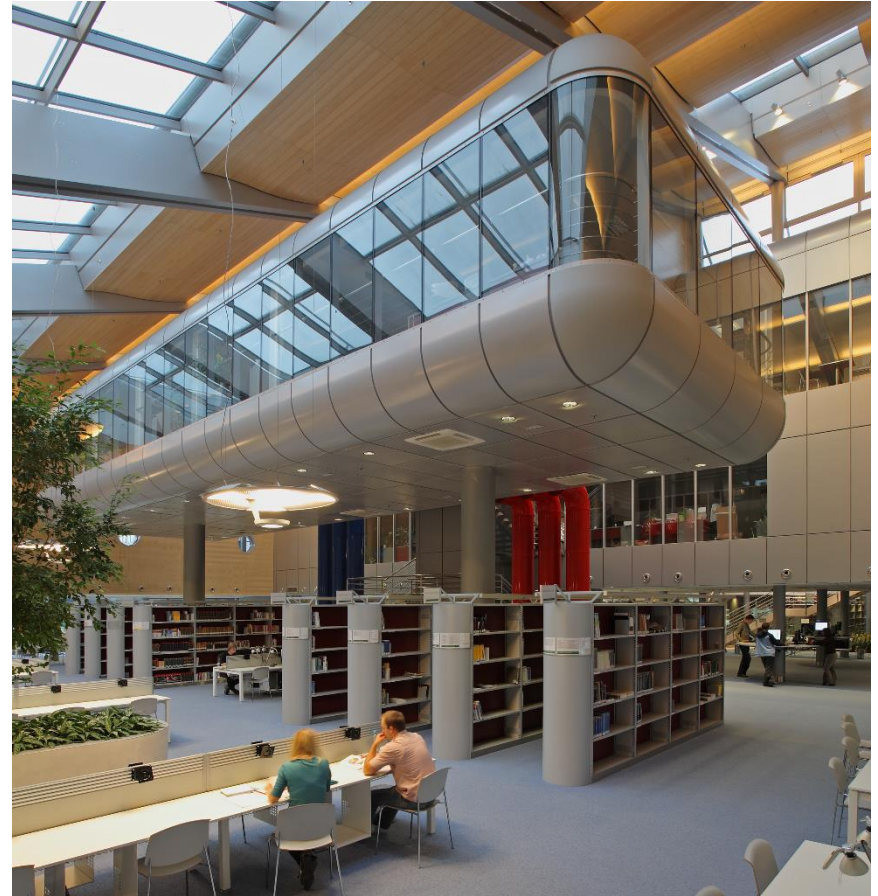

LIBRARY



MUNI



Co-funded by the
Erasmus+ Programme
of the European Union



ANATOMY DPT.
CHEMISTRY DPT.



MUNI



Co-funded by the
Erasmus+ Programme
of the European Union



Faculty hospital of St. Anne

CLINICAL EDUCATION TAKES PLACE AT BOHUNICE FACULTY HOSPITAL, CHILDREN'S MEDICAL CENTRE, AND ST. ANNE'S HOSPITAL

3 100 BEDS FULLY ACCESSIBLE FOR
TEACHING



MUNI



Co-funded by the
Erasmus+ Programme
of the European Union

- GENERAL MEDICINE
- DENTISTRY
- PHYSIOTHERAPY

DEGREE
PROGRAMMES
IN ENGLISH



MUNI



Co-funded by the
Erasmus+ Programme
of the European Union



- 150 INTERNATIONAL STUDENTS ARE ACCEPTED EVERY YEAR
- ALL TEACHING IS PROVIDED IN ENGLISH LANGUAGE
- THE CURRICULUM IN GENERAL MEDICINE LASTS 6 YEARS
- THE PROGRAMME IS CONCLUDED WITH THE DEGREE OF "MEDICINAE UNIVERSAE DOCTOR" (MUDR. = M.D., DOCTOR OF GENERAL MEDICINE)
- THE TUITION IS DIVIDED INTO A PRE-CLINICAL AND CLINICAL PART

GENERAL MEDICINE



M U N I



Co-funded by the
Erasmus+ Programme
of the European Union

- ONE ACADEMIC YEAR IS DIVIDED IN TWO SEMESTERS WHICH CONSIST OF 15 WEEKS EACH, FOLLOWED BY 6 WEEKS OF EXAMINATION PERIOD
- THE FIRST TWO YEARS OF STUDY ARE THEORETICAL
- ESSENTIAL COURSES ARE CHEMISTRY, BIOLOGY, LATIN, ANATOMY, BIOCHEMISTRY, HISTOLOGY AND EMBRYOLOGY, PHYSIOLOGY
- THE THIRD YEAR OF STUDY INCLUDES PRE-CLINICAL COURSES SUCH AS, PATHOLOGY, PATHOPHYSIOLOGY, IMMUNOLOGY, MICROBIOLOGY, AND ALSO INSTRUCTIONS IN PRACTICAL APPROACH TO EXAMINING PATIENTS
- ALL STUDENTS HAVE MANDATORY CZECH LANGUAGE COURSES



PRE-CLINICAL YEARS GENERAL MEDICINE

- THE FOURTH AND FIFTH YEARS CONSIST OF PRACTICAL BLOCKS OF 1-2 WEEKS IN HOSPITALS
- BLOCKS CONSISTS OF LECTURES AND PRACTICAL TRAINING ON PATIENTS
- PHARMACOLOGY, INTERNAL MEDICINE, SURGERY, ORTOPEADICS, GYNECOLOGY AND OBSTETRICS, PSYCHIATRY, FORENSIC MEDICINE, INTENSIVE CARE, OPHTHALMOLOGY, NEUROLOGY, PAEDIATRICS, ONCOLOGY ETC.
- EXAMS CAN BE DONE AFTER EACH PRACTICAL BLOCK



CLINICAL YEARS GENERAL MEDICINE

- THE SIXTH AND FINAL YEAR OF STUDY CONSISTS OF HOSPITAL INTERNSHIP AND STATE EXAMS
- INTERNAL MEDICINE (7 WEEKS)
- SURGERY (5 WEEKS)
- FAMILY MEDICINE (4 WEEKS)
- PEDIATRICS (2 WEEKS)
- GYNECOLOGY AND OBSTETRICS (1 WEEK)



SIXTH YEAR (STATE EXAMS) GENERAL MEDICINE



- THE CURRICULUM IN DENTISTRY LASTS 5 YEARS
- COMPATIBLE WITH CURRENT EUROPEAN STANDARDS
- THE PROGRAMME IS CONCLUDED WITH THE DEGREE OF "MEDICINAE DENTIIUM DOCTOR" (MDDR. = DOCTOR OF DENTISTRY)
- THE TUITION IS DIVIDED INTO A PRE-CLINICAL AND CLINICAL PART

DENTISTRY



M U N I



Co-funded by the
Erasmus+ Programme
of the European Union

- THE FIRST TWO YEARS INCLUDE EXTENSIVE COURSES IN PRECLINICAL DENTISTRY, GNATHOLOGY, PROSTHETIC TECHNOLOGY – MATERIALS, AND PREVENTIVE DENTISTRY, TOGETHER WITH SOME THEORETICAL GENERAL-MEDICINE COURSES AS MEDICAL PHYSICS AND INFORMATICS, BIOLOGY, MEDICAL CHEMISTRY, BIOCHEMISTRY, ANATOMY, ETC.)



YEARS 1 & 2 DENTISTRY

- THE THIRD YEAR: PRE-CLINICAL COURSES (PATHOLOGICAL ANATOMY, PATHOLOGICAL PHYSIOLOGY, CLINICAL EXAMINATION IN INTERNAL MEDICINE AND SURGERY ETC.)
- DENTISTRY COURSES ARE TAUGHT IN A REDUCED EXTENT WITH SPECIAL ATTENTION PAID TO ORAL AND DENTAL PROBLEMS
- THE 5TH - 10TH TERMS: INTENSIVE, SPECIALISED INSTRUCTION IN DENTISTRY COURSES
- 4 BLOCKS OF VACATIONAL PRACTICAL TRAINING



- THE FIFTH YEAR: STATE DOCTORAL EXAMS
 - THERAPEUTIC STOMATOLOGY
 - SURGICAL STOMATOLOGY
 - ORTHOPAEDIC STOMATOLOGY

YEARS 3 & 5

DENTISTRY



- THE CURRICULUM IN PHYSIOTHERAPY LASTS 3 YEARS
- COMPATIBLE WITH CURRENT EUROPEAN STANDARDS
- THE PROGRAMME IS CONCLUDED WITH THE DEGREE OF „SCIENTIAE BACCALAUREUS" (BC. = BACHELOR OF SCIENCE)
- POSSIBILITY OF A FOLLOWING MASTER'S PROGRAMME OF PHYSIOTHERAPY

PHYSIOTHERAPY



MUNI



Co-funded by the
Erasmus+ Programme
of the European Union

- STUDENTS GAIN CORE SKILLS AND KNOWLEDGE OF
 - MUSCULOSKELETAL CLINICAL SCIENCE
 - CARDIO-RESPIRATORY CLINICAL SCIENCE
 - NEUROMUSCULAR CLINICAL SCIENCE
 - ANATOMY
 - PHYSIOLOGY
 - PATHOPHYSIOLOGY
 - BIOCHEMISTRY
 - BIOPHYSICS
 - PSYCHOLOGY
 - PSYCHIATRY
 - EPIDEMIOLOGY
 - ETHICS
 - CZECH LANGUAGE
- GRADUATES CAN FUNCTION AS INDEPENDENT CLINICIANS IN HOSPITAL DEPARTMENTS OR OTHER HEALTH CARE FACILITIES, INCL. SPAS AND WELLNESS CENTRES



- THE THIRD YEAR: STATE EXAMS
 - KINESIOTHERAPY - PRACTICAL EXAM
 - KINESIOTHERAPY
 - COMPREHENSIVE REHABILITATION
 - DIPLOMA THESIS DEFENCE

YEARS 1-3

PHYSIOTHERAPY

- EVERY APPLICANT MUST FINISH SUCCESSFULLY AT LEAST 4 (OR 3) YEARS OF STUDIES AT A SECONDARY SCHOOL (HIGH SCHOOL) CONCLUDED BY A SCHOOL-LEAVING EXAMINATION.
- THE APPLICANTS ARE ACCEPTED ON THE BASIS OF A WRITTEN ENTRANCE EXAMINATION IN THE FOLLOWING SUBJECTS:

GENERAL MEDICINE & DENTISTRY:

CHEMISTRY, BIOLOGY, PHYSICS OR
MATHEMATICS

PHYSIOTHERAPY:

CHEMISTRY, BIOLOGY

- EACH TEST CONTAINS 40 QUESTIONS.

HOW TO BE ADMITTED



M U N I



Co-funded by the
Erasmus+ Programme
of the European Union

- GENERAL MEDICINE:

CZK 249,000 PER ACADEMIC YEAR (APPROX. € 9,800)

- DENTISTRY:

CZK 298,000 PER ACADEMIC YEAR (APPROX. € 11,200)

- PHYSIOTHERAPY:

CZK 195,000 PER ACADEMIC YEAR (APPROX. € 7,300)

T U I T I O N F E E S



M U N I



Co-funded by the
Erasmus+ Programme
of the European Union



- VINARSKÁ HALL
(CAPACITY OF 1,115 BEDS)
- ALL ROOMS HAVE AN INTERNET CONNECTION, A BATHROOM, A KITCHENETTE

RESIDENCE HALLS



MUNI



Co-funded by the
Erasmus+ Programme
of the European Union

FACULTY OF NE HAS ITS OWN ASSOCIATION OF INTERNATIONAL STUDENTS (MIMSA) WHICH PROVIDES:

- SOCIAL ACTIVITIES, SPORTING EVENTS, PARTIES ETC.
- TRIPS TO OTHER PARTS OF THE CZECH REPUBLIC AND ABROAD
- ASSISTANCE FOR NEW STUDENTS DURING THE ORIENTATION WEEK AND STUDY SESSIONS WITH OLDER STUDENTS



STUDENT ACTIVITIES

- MASARYK UNIVERSITY, FACULTY OF MEDICINE (WWW.MED.MUNI.CZ)
- ACCOMMODATION & CATERING SERVICES (WWW.SKM.MUNI.CZ)
- MASARYK INTERNATIONAL MEDICAL STUDENT ASSOCIATION (WWW.MIMSA.CZ)
- VIRTUAL TOUR AROUND THE CAMPUS (WWW.MUNI.CZ/KAMPUS?LANG=EN)
- GENERAL INFO ABOUT THE CITY OF BRNO (WWW.BRNO.CZ)

MUNI
MED



WEB RESOURCES



MUNI



Co-funded by the
Erasmus+ Programme
of the European Union